

Swimming pool Light

4.2000

- Protection class IP68 – for a water depth of up to 3 m
- Spotlight housing entirely made of stainless steel 316Ti 1.4571
- ...
- POW-LED cold white, warm white, neutral white
- Multichip POW-LED RGB-W
- Operating mode mono: constant voltage
- Operating mode RGB-W: constant current
- Temperature controlled (onboard); surge protection
- Light distribution especially for swimming pool lighting „asymmetric Mixflux“
- ...
- For competition pools and sports pools with walkaround or surrounding shaft
- Wall installation in all standard pool types
- Incl. end cover with integrated access port
- Constant-voltage power source/RGB-W controller ordered separately
- Supplied with 2 m of special underwater cable



IP68	STAINLESS STEEL V4A 1.4571 316Ti	POW-LED INCL.	3.000 K 4.500 K 6.000 K RGB-W	CONSTANT CURRENT CONSTANT VOLTAGE	CABLE INCL.	max 3m	←
	CE						

[00] Tiled concrete pools (tiles+ mortar 15–20 mm)

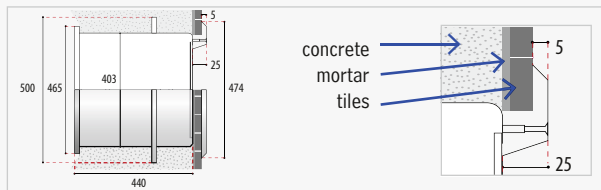

[04] Stainless steel pools (welded flange)

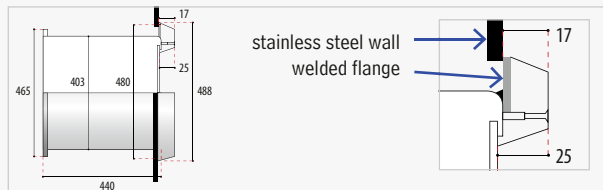

[01] Concrete pools with fitted foil (pressure flange)

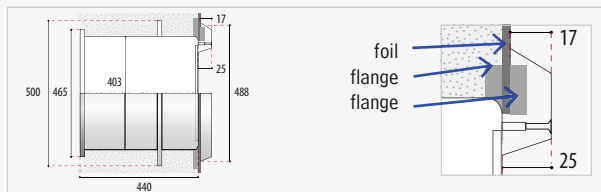

[50] Tiled pools with movable floors (tiles+ mortar 16–20 mm)

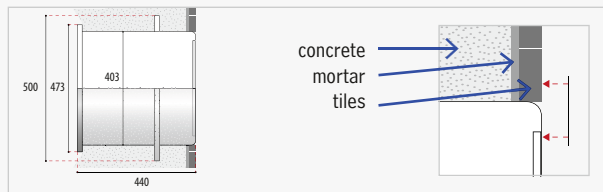

[03] Pools with adhesive/foil coatings (adhesive flange)

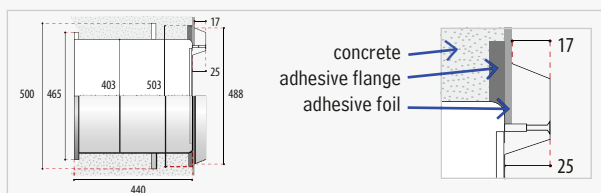

[60] later installation (tiles+ mortar 15–20 mm)

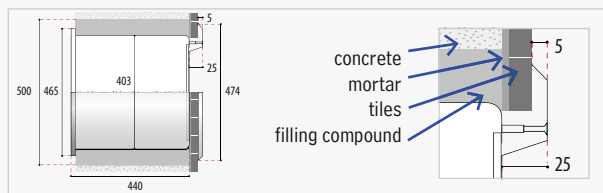

housing extension
per each 400 mm
9.2020.00.00

housing shorten
minimal 290 mm
9.2021.00.00

Customer-specific
installations and
special designs
available on request.

*Total length of the
light 4.2002 = length
+ 70 mm

Underwater environments only

Monochrome and dynamic illumination

#	Color	Lumen	LED	Watt	Power	Beam	Cable	Connect → 208
4.2002. [] .11*	6500K cold white	25000 lm	High-POW-LED	total 170 W	CV 12 V-DC	flood	incl.	integrated
4.2002. [] .12*	3000K warm white	20110 lm						
4.2002. [] .13*	4000K neutral white	21680 lm						
4.2003. [] .11	6000K cold white	18600 lm	32 POW-LED	total 124 W	CV 12 V-DC	asymmetric Mixflux	UW, 5x1,5 qmm	5.0630.20.32 max 1
4.2003. [] .12	3000K warm white	15040 lm						
4.2003. [] .13	4500K neutral white	16080 lm						
4.2003. [] .41	RGB-CW cold white 6000K	cold white: 4640 lm	32 Multichip POW-LED	all on 152 W	CC max 24 V-DC	asymmetric Mixflux	UW, 10x0,5 qmm	5.0670.69.52 max 1
4.2003. [] .42	RGB-WW warm white 3000K	warm white: 4020 lm						
4.2003. [] .43	RGB-NW neutral white 4500K	neutral white: 4320 lm						

[] Complete the article number with the code of the installation variant